

# ADAM System

## *Airway Delivery And Management*

The ADAM (Airway Delivery And Management) CPAP System provides a unique, comfortable solution for administering nasal CPAP. Because the ADAM nasal pillows overcome the drawbacks and problems associated with standard nasal masks, patients find it easier to accept nasal CPAP therapy and use it consistently.



Presented With Compliments From  
[www.DirectHomeMedical.com](http://www.DirectHomeMedical.com)

# ADAM System

## AIRWAY DELIVERY AND MANAGEMENT\*

The ADAM system uses innovative nasal pillows to seal directly at the patient's nostrils. This avoids the claustrophobic sensation of a mask and virtually eliminates air leaks. Soreness on the bridge of the nose and air leaks which irritate the eyes are also eliminated. Plus, the ADAM system is effective with patients who have mustaches or beards. ADAM nasal pillows are made of medical-grade silicone and are available in six different sizes to fit a range of patients. They are held in place by the ADAM shell, which is positioned directly under the nose and available in both regular and narrow sizes. A vent hole in the shell allows for exhalation and purging carbon dioxide. A swivel adapter connects the shell and tubing

and keeps the nasal pillows in place during sleep. The circuit is held in place by the ADAM SnugFit® headgear which is lightweight, cool, and adjustable. SnugFit headgear is available in reusable as well as disposable versions. The headgear stabilises the tubing and routes it over the patient's head for greater freedom. Because the sealing area of the pillows is small and the circuit is light weight, less effort is required to hold it in place and pressure to the patient's face is minimised. For home or sleep lab use, the ADAM system provides the ultimate in patient comfort.

\* U.S. Patent No. 4,782,832

- Unique design is lighter and more comfortable than nasal masks
- Nasal pillows seal gently at the nostrils to reduce leaks
- Velcro® fasteners permit maximum versatility in fitting and adjusting headgear
- Swivel adapter provides stress relief between tubing and shell to avoid dislodging nasal pillows
- Tubing is routed over patient's head, permitting freedom of movement
- Six sizes of nasal pillows, two sizes of CPAP shell, and one size SnugFit headgear help ensure proper fit for a wide range of patients
- Reusable and disposable headgear are available for both sleep lab and home use
- One size SnugFit headgear fits adults or children



## ADAM CPAP SYSTEM

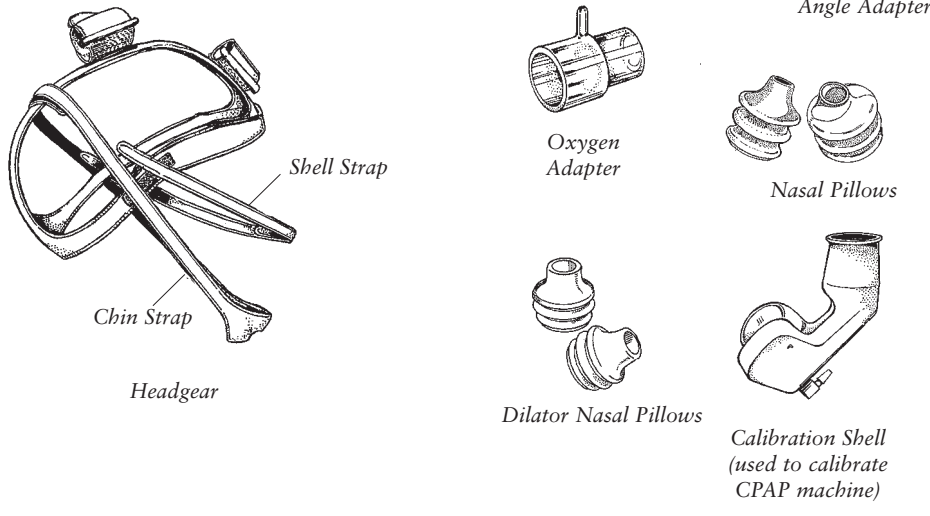
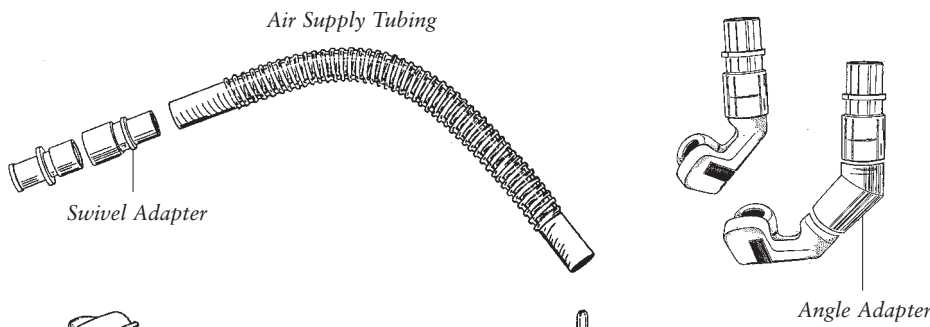
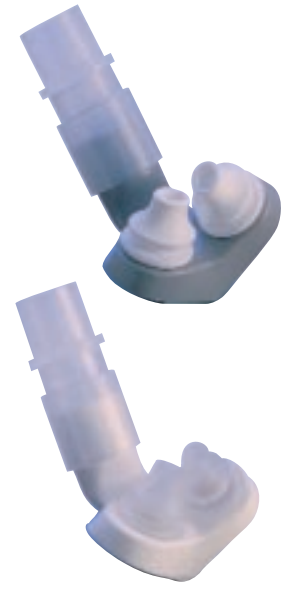
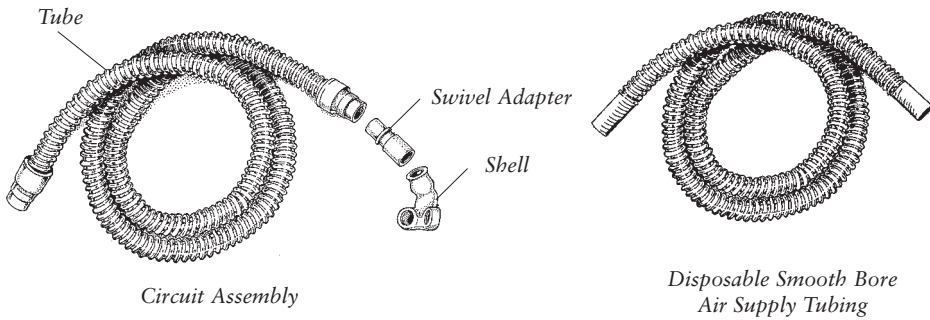

## ADAM VENTILATION SYSTEM

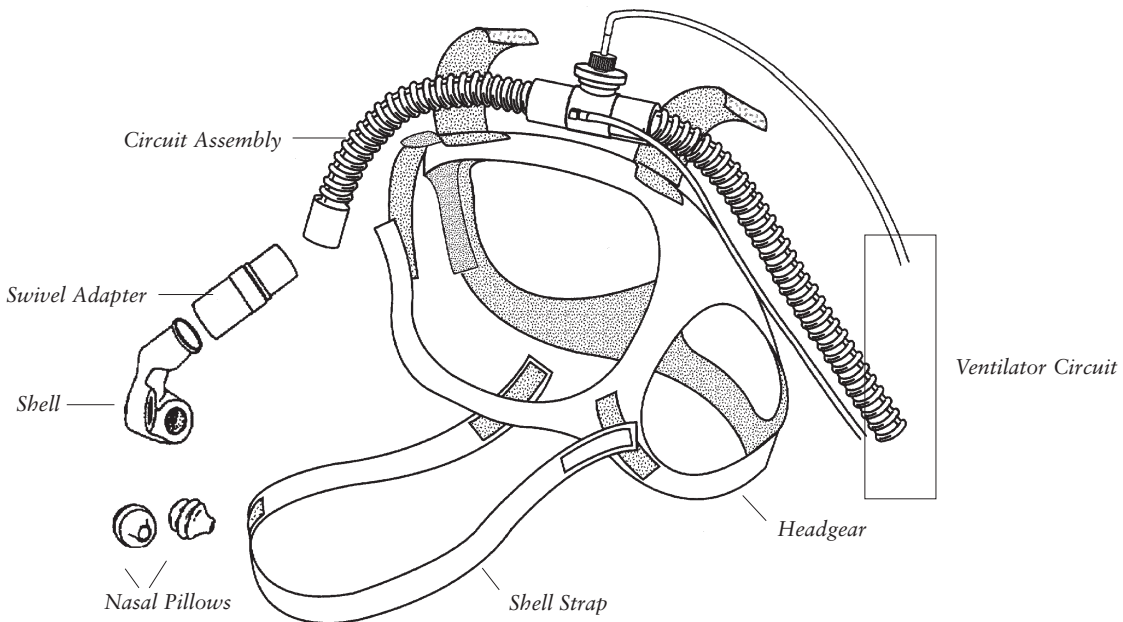



### TECHNICAL SPECIFICATIONS

#### Materials of Construction

- SnugFit Headgear: Black nylon laminated to lycra material with neoprene
- Disposable SnugFit Headgear: White nylon laminate
- Nasal Pillows: Medical-grade silicone
- Shell: Polypropylene
- Swivel Adapter: Polypropylene
- Reusable Hose: Hytrel® (polyester copolymer) and silicone
- Disposable Hose: Ethylene vinyl acetate copolymer

#### Hose Attachment Size

- Fits 22 mm OD connection

#### Compliance

- CE marking approved, indicating compliance to the Medical Device Directive (93/42/EEC)

### ORDERING INFORMATION

For a complete patient circuit, order a headgear, circuit assembly and nasal pillows. Order other accessories as needed. Circuit assemblies include smooth bore tube, swivel adapter, and shell.

#### Headgear

- |             |  |
|-------------|--|
| S-133317-00 | SnugFit headgear (black) one size fits all with shell strap                    |
| S-133321-00 | Disposable SnugFit headgear (white) one size fits all with shell strap (5/pkg) |

#### Circuit Assemblies

- |             |  |
|-------------|--|
| S-133293-00 | Circuit assembly without pressure tap (for home use)   |
| S-133294-00 | Circuit assembly with pressure tap (for sleep lab use) |
| S-133283-00 | Circuit Assembly for non-invasive Ventilation          |

#### Nasal Pillows

- |             |  |
|-------------|--|
| S-616323-00 | Nasal pillows, small (one pair, blue)          |
| S-616324-00 | Nasal pillows, medium (one pair, clear)        |
| S-616325-00 | Nasal pillows, large (one pair, green)         |
| S-616355-00 | Dilator nasal pillow, small (one pair, grey)   |
| S-616356-00 | Dilator nasal pillow, medium (one pair, white) |
| S-616357-00 | Dilator nasal pillow, large (one pair, yellow) |

#### Accessories

- |             |   |
|-------------|---|
| S-616155-03 | Oxygen adapter                                  |
| S-616369-00 | Angle adapter                                   |
| S-231702-00 | CPAP calibration shell                          |
| S-232102-00 | Narrow clinical shell with thermistor ports     |
| S-232101-00 | CPAP shell, narrow                              |
| S-231699-00 | CPAP shell with thermistor ports                |
| S-133324-00 | Air supply tubing (37,5 cm) with swivel adapter |
| S-133350-00 | Flex tube assembly with swivel adapter          |
| S-133318-00 | Chin strap (black)                              |

#### Replacement Parts

- |             |  |
|-------------|--|
| S-231700-00 | CPAP shell without pressure tap                          |
| S-231701-00 | CPAP shell with pressure tap                             |
| S-133292-00 | Smooth bore air supply tubing, 180 cm                    |
| S-776274-00 | Smooth bore air supply tubing, 240 cm                    |
| S-616329-00 | Swivel Adapter   |
| S-133319-00 | Shell Strap (black)                                      |
| S-133325-00 | Disposable smooth bore air supply tubing, 15 cm (6/case) |

CE marked, indicating compliance to the European Medical Device Directive (93/42/EEC).

Snugfit is a trademark of Mallinckrodt Inc. Specifications are subject to change without notice.  
© 1999 Mallinckrodt. All rights reserved.

MS-ADAMENG

