

1 What is in the box

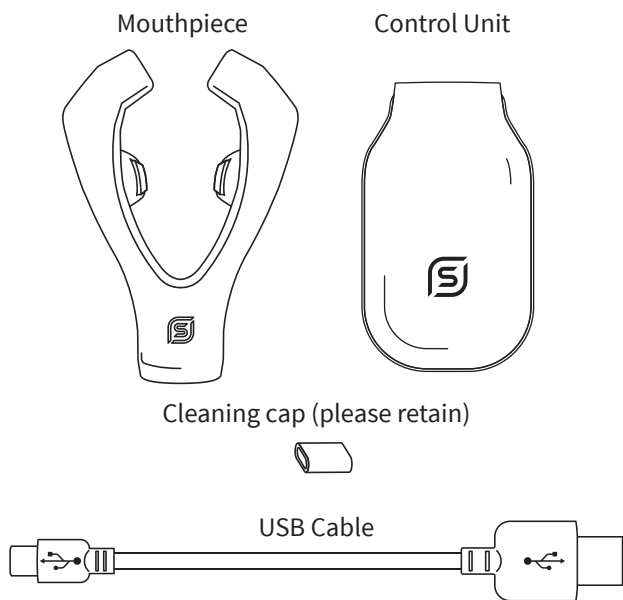

2 First charge

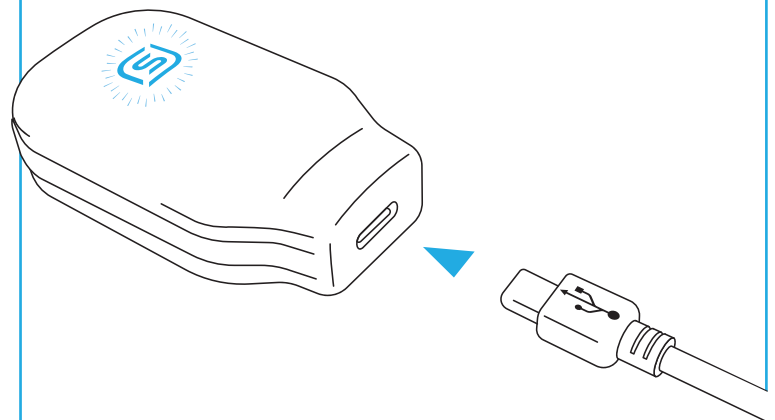

Only use the USB cable provided.

When charging the blue light will flash, if this does not happen please contact us.

3 How to connect

1

Download the eXciteOSA app and sign up.



Available on the App Store

ANDROID APP ON Google Play

2

Connect the mouthpiece to the control unit.

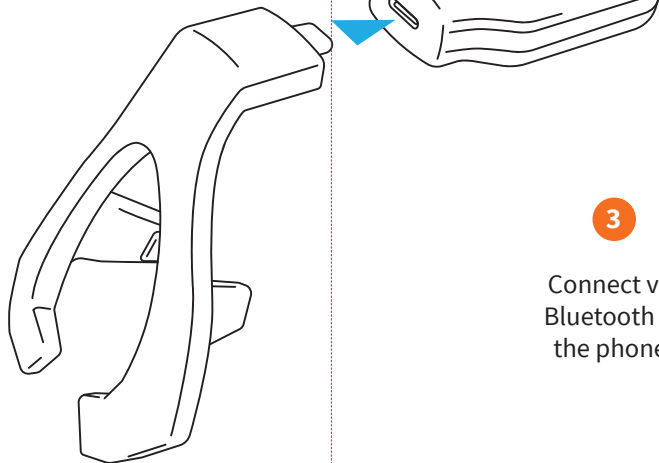

3

Connect via Bluetooth to the phone.



4 How to place the device on your tongue

Insert the mouthpiece into the mouth and allow it to sit around the tongue and gently close your mouth.

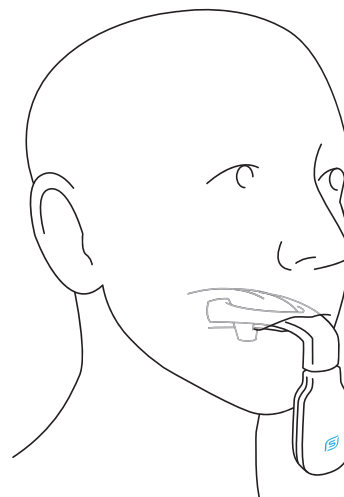
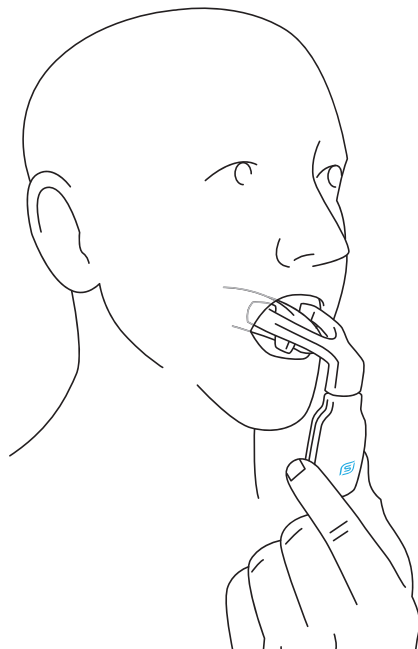

Avoid grinding or clenching the mouthpiece.

Remember: Disconnect the mouthpiece from the control unit after each therapy session and replace the cleaning cap.

