

# Mirage™ SoftGel

NASAL MASK



## Components Card

### Complete system

M 61601

L 61602

### Frame system\*

(no headgear)

**61627 (M)**

**61628 (L)**

### Frame assembly\*

(no headgear, no cushion)

**60175 (St)**

### Elbow assembly

(elbow, swivel)

**16399**

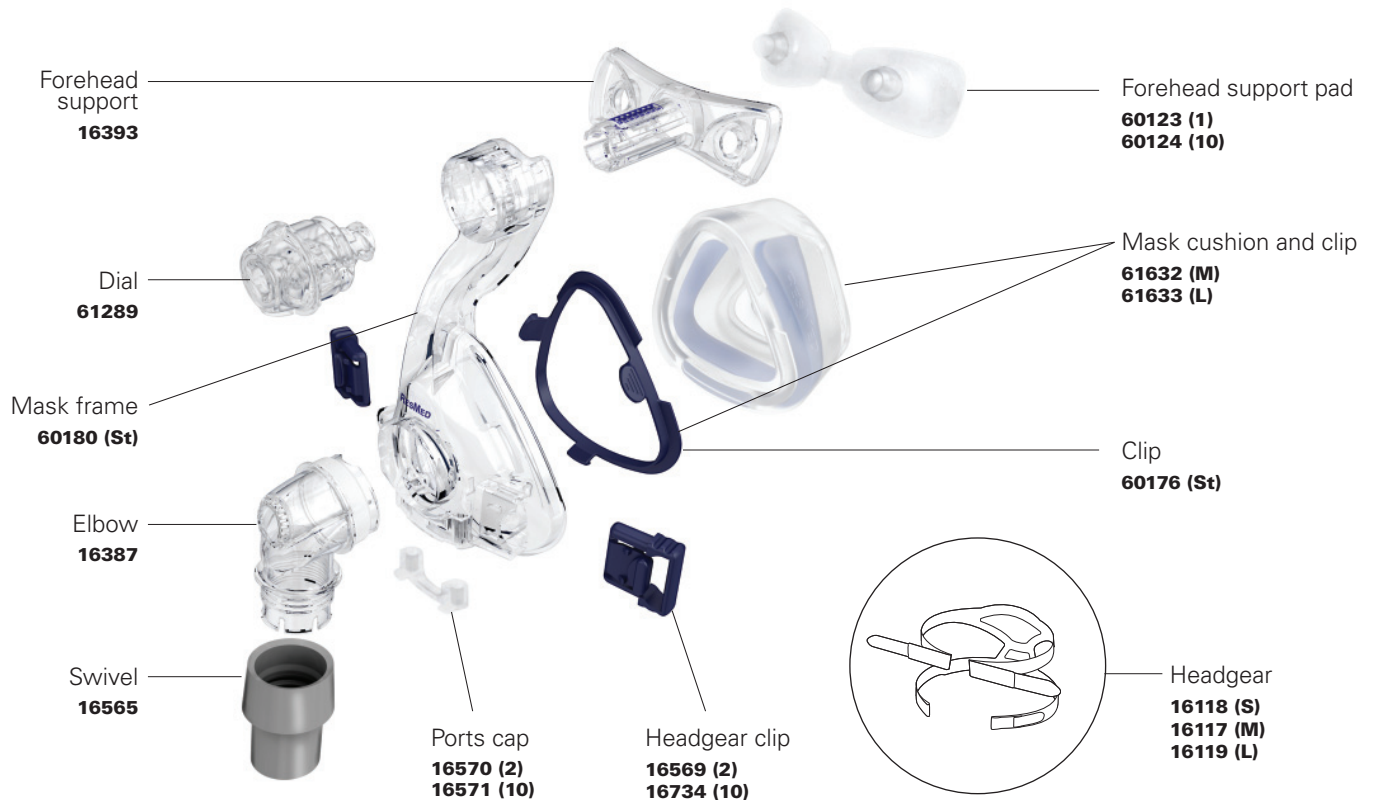

M Medium

L Large

St Standard

\* contains headgear clips



For details, refer to the  
*Mirage SoftGel Nasal Mask User Guide.*