

CPAP Pro "No Mask" Parts Diagram

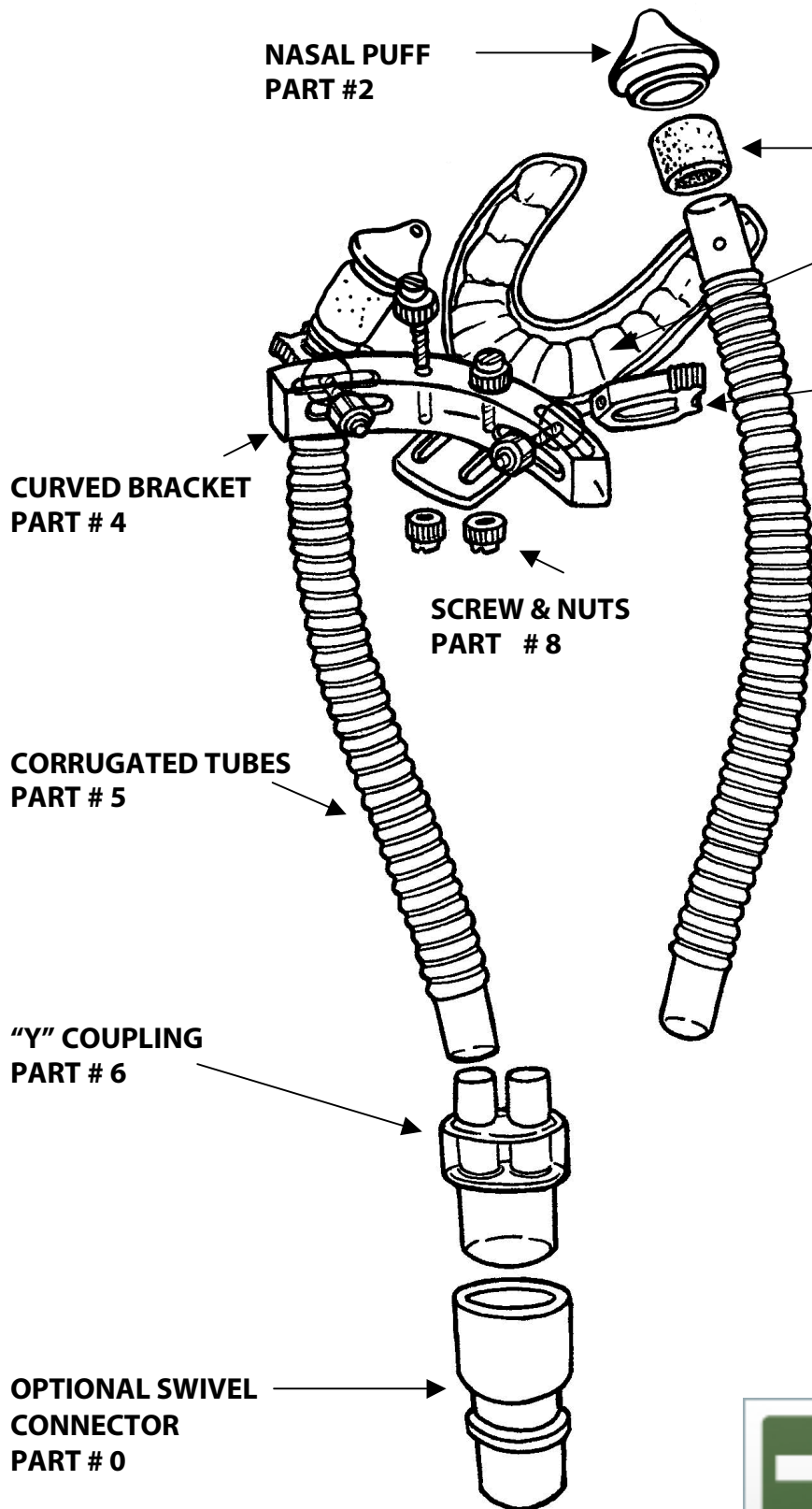

**NASAL PUFF
PART #2**

**DIFFUSERS
PART #7**

**MOUTHPIECE
PART #1**

**HOSE CLAMPS
PART #3**

**CURVED BRACKET
PART #4**

**SCREW & NUTS
PART #8**

**CORRUGATED TUBES
PART #5**

**"Y" COUPLING
PART #6**

**OPTIONAL SWIVEL
CONNECTOR
PART #0**

#1 Heat Formed Mouthpiece - Holds the CPAP PRO firmly in place. Replace on average every 3 months.

#2 Nasal Puff Assembly - Special nose-fitting seals attached to the top of the CPAP PRO. Replace on average every 3 months.

#3 Adjustable Hose Clamps - Clamps hold the plastic tubes in place. Replace on average every 6 months.

#4 Curved Bracket - Main plate that holds the CPAP PRO assembly. Replace as needed.

#5 Corrugated Tubes - Tubes that connect the Nasal puff assembly to the Y coupling. Replace on average every 3 months.

#6 Y Coupling - Connects the corrugated tubes together. Replace as needed.

#7 Diffusers - Replace on average every two weeks

#8 Screws & Nuts - Hold the mouthpiece to the curved bracket. Replace on average every 6 months.

#0 Optional Swivel Connector - Helps prevent 'kink' in hoses. Replace as needed.



Presented With Compliments From
www.DirectHomeMedical.com